

Go to www.vtechphones.com to register your product for enhanced warranty support and latest VTech product news.

SN6187
VTech CareLine™



Congratulations

On purchasing your new VTech product. Before using this telephone, please read **important safety instructions**.

This abridged user's manual provides you with basic installation and use instructions. A limited set of features are described in abbreviated form.

Please refer to the online user's manual for a full set of installation and operation instructions at www.vtechphones.com.



Telephones identified with this logo have reduced noise and interference when used with most T-coil equipped hearing aids and cochlear implants. The TIA-1083 Compliant Logo is a trademark of the Telecommunications Industry Association. Used under license.



The ENERGY STAR® program (www.energystar.gov) recognizes and encourages the use of products that save energy and help protect our environment. We are proud to mark this product with the ENERGY STAR® label indicating it meets the latest energy efficiency guidelines.

What's in the box

Your telephone package contains the following items. Save your sales receipt and original packaging in the event warranty service is necessary.

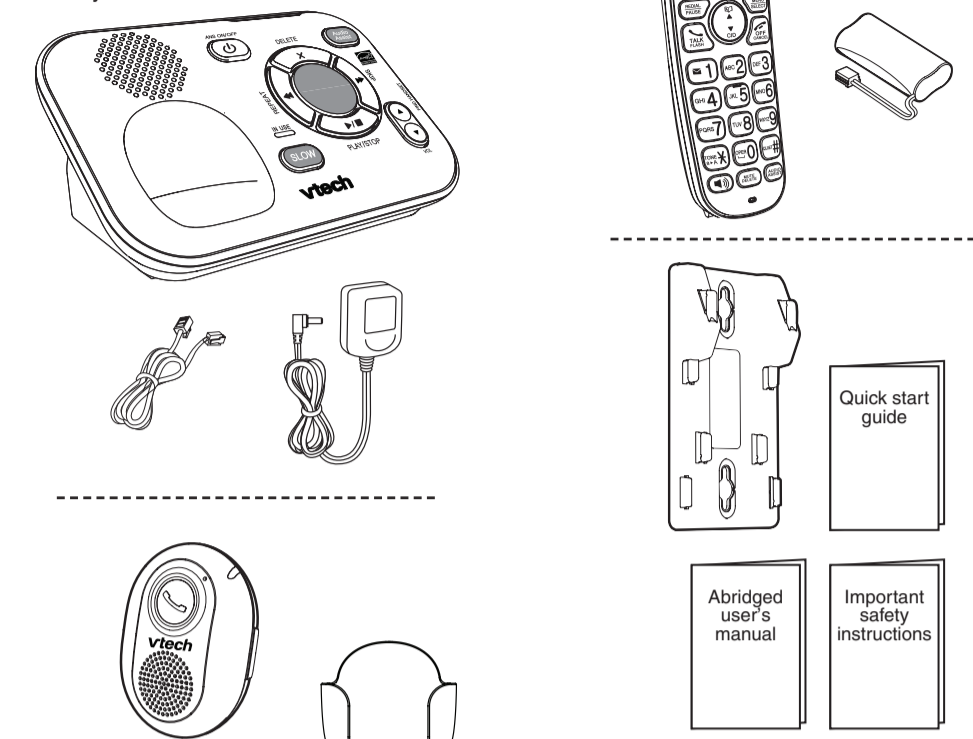

Abridged user's manual

Install and charge the battery

Install the battery
Install the battery as shown below.

- NOTES**
- For best performance, keep the handset in the telephone base or charger when not in use.
- The battery is fully charged after 11 hours of continuous charging.
- If you place the handset in the telephone base or the charger without plugging in the battery, the screen displays **No battery**.

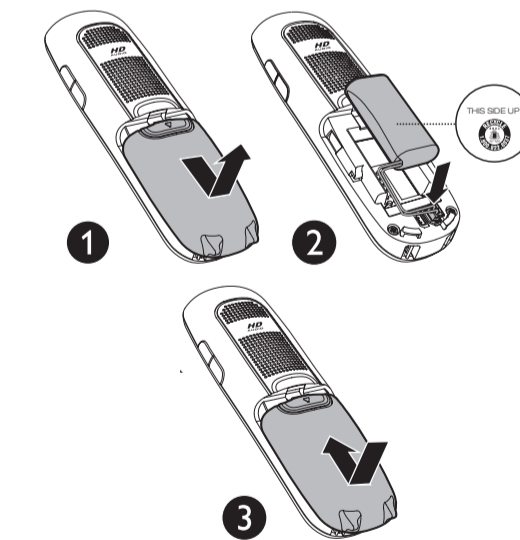

Charge the handset battery
Place the handset in the telephone base or the charger to charge.

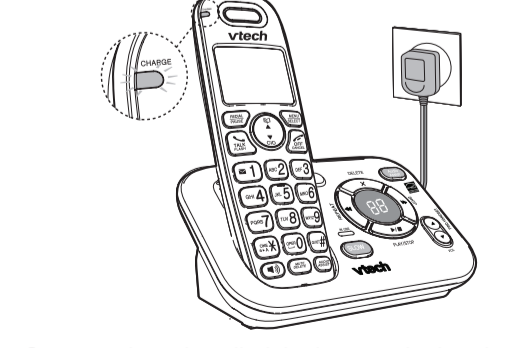

Once you have installed the battery, the handset LCD display indicates the battery status (see the following table).

Battery indicators	Battery status	Action
The screen is blank, or displays Place in charger and [] flashes.	The battery has no or very little charge. The handset cannot be used.	Charge without interruption (at least 30 minutes).
The screen displays Low battery and [] flashes.	The battery has enough charge to be used for a short time.	Charge without interruption (about 30 minutes).
The screen displays HANDSET X .	The battery is charged.	To keep the battery charged, place it in the telephone base or charger when not in use.

Charge the pendant battery
Switch on the pendant, and then place it in the pendant charger to charge.

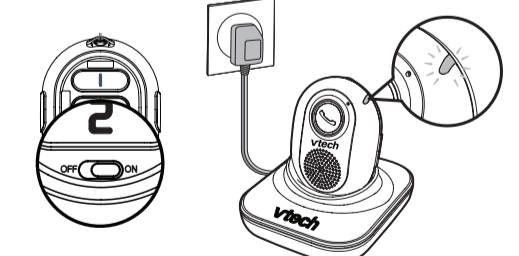

The pendant status light indicates the battery status (see the following table).

- NOTES**
- For best performance, keep the pendant in the pendant charger when not in use.
- The battery is fully charged after 3 hours of continuous charging.

Battery indicators	Battery status	Action
The pendant status light flashes red.	The battery has very little charge.	Charge without interruption.
You hear "Low battery" when there is only 30 minutes talk time left. You hear an alert tone every one minute.	The battery has enough charge to be used for a short time.	Charge without interruption.
The pendant status light is solid red.	The battery has enough charge to be used for a short time.	Charge without interruption.

Battery backup
When there is a power failure, all handsets display **Put HS on base to power base**. Put a charged handset in the telephone base to back up the telephone base power for some basic phone operations for a short period of time. During this period, you cannot use the answering system. If you have a pendant, you cannot use its voice command feature.

When a handset is put in the telephone base, it displays **Powering base... Don't pick up**. At this time, you may use other handsets for some basic phone operations. You may use the handset which is put in the telephone base for making or answering calls via the handset speakerphone, but do not pick up the handset while using it.

- NOTE**
- When the cordless handset you put in the base does not have enough charge to back up the telephone base power, the handset displays **Not enough batt to power base**.

Before use

After you install your telephone or power returns following a power outage, the handset will prompt you to set the date and time.

Set date and time

- NOTE**
- Make sure you set the date and time including the year correctly; otherwise the answering system does not announce the correct day of the week for your recorded messages time stamp.

- Use the dialing keys (0-9) to enter the month (MM), date (DD) and year (YY). Then press **SELECT**.
- Use the dialing keys (0-9) to enter the hour (HH) and minute (MM). Then press **▼** or **▲** to choose **AM** or **PM**.
- Press **SELECT** to save.

Telephone base overview

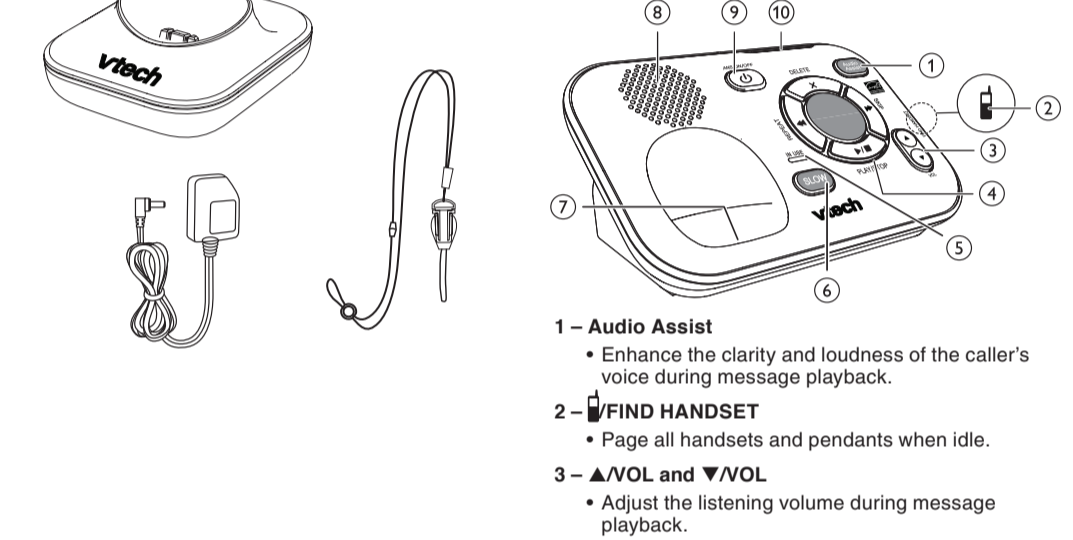

- Audio Assist**
Enhance the clarity and loudness of the caller's voice during message playback.
- FIND HANDSET**
Page all handsets and pendants when idle.
- ▲/VOL and ▼/VOL**
Adjust the listening volume during message playback.

Handset overview

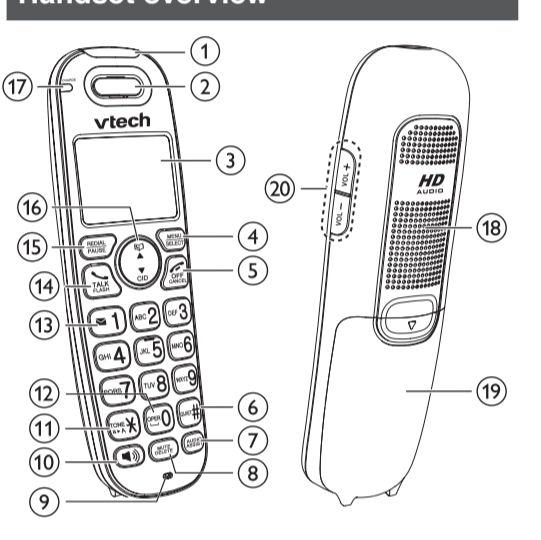

- Microphone**
Make or answer a call using the handset speakerphone.
- Speakerphone**
Switch between the handset speakerphone and the handset earpiece during a call.
- MUTE**
Mute the microphone during a call.
- Speakerphone**
Silence the handset ringer temporarily while the phone is ringing.
- Microphone**
Delete the displayed entry while reviewing the phonebook, caller ID log or redial list.
- DELETE**
Delete digits or characters when entering numbers or names.
- MICROPHONE**
Enter space character during text editing.
- 1**
Press repeatedly to add or remove 1 in front of the caller ID log entry before dialing or saving it to the phonebook.
- FLASH**
Make or answer a call.
- ANSWER**
Answer an incoming call when you receive a call waiting alert.

- Use the dialing keys (0-9) to enter the month (MM), date (DD) and year (YY). Then press **SELECT**.
- Use the dialing keys (0-9) to enter the hour (HH) and minute (MM). Then press **▼** or **▲** to choose **AM** or **PM**.
- Press **SELECT**.

Caller ID announce
The caller ID announce feature lets you know who's calling without having to look at the display. When you have an incoming call, the handset and/or the telephone base speaks "Call from..." and the name of the caller based on the phonebook or caller ID information. If the caller's name is private or unknown, the phone number up to the last 11 digits will be announced. If the caller's phone number is also private or unknown, no information will be announced.

- Press **MENU** when the handset is not in use.
- Press **▼** or **▲** to choose **AnnC Caller ID** and then press **SELECT**.
- Press **▼** or **▲** to choose a desired option and then press **SELECT**.
- Press **▼** or **▲** to choose **On** or **OFF**, and then press **SELECT**.

- NOTE**
- To use the caller ID announce feature, you must subscribe to caller ID service from your telephone service provider.

Talking digit
You can select the volume or turn off the audible spoken tone that is spoken when you press the dialing key during redialing.

- Press **MENU** on the handset when not in use.
- Press **▼** or **▲** to choose **Settings** and then press **SELECT**.
- Press **SELECT**.
- Press **▼** or **▲** to choose **Happy message** and then press **SELECT**.
- Press **▼** or **▲** to choose **On** or **OFF**, and then press **SELECT**.

Happy message
Happy messages are pendant greeting messages. It will occur when you pick up the pendant in the morning (between 4:30 am and 9:00 am), place the pendant on its charger at night (between 8:00 pm and 11:00 pm), or after using the voice command feature.

- NOTE**
 - Make sure you set the date and time including the year correctly; otherwise the answering system does not announce the correct day of the week for your recorded messages time stamp.
- Press **MENU** on the handset when not in use.
 - Press **▼** or **▲** to choose **Pendant** and then press **SELECT**.
 - Press **▼** or **▲** to choose **Happy message** and then press **SELECT**.
 - Press **▼** or **▲** to choose **On** or **OFF**, and then press **SELECT**.

Temporary tone dialing

If you have pulse (rotary) service only, you can switch from pulse to touch-tone dialing temporarily during a call.

- During a call, press **TONEX**.
- Use the dialing keys to enter the relevant number. The telephone sends touch-tone signals. It automatically returns to pulse dialing mode after you end the call.

Speed dial

There are two speed dial keys, 1 and 2, on the pendant. Use a handset to store two contacts that you may need to call them more often or right away.

- Assign or edit a speed dial entry**
- Press **MENU** when the handset is not in use.
- Press **▼** or **▲** to scroll to **Pendant** then press **SELECT**.
- Press **▼** or **▲** to scroll to **Memory 1** or **Memory 2** and then press **SELECT**.
- Use the dialing keys to enter the number.
- Press **SELECT** to move on to enter the name.
- Use the dialing keys to enter the name.
- Additional key presses show other characters of that particular key.
- Press **SELECT** to save.

- While entering names and numbers, you can:
- Press **DELETE** to backspace and erase a digit or character.
- Press and hold DELETE** to erase the entire entry.
- Press **▼** or **▲** to move the cursor to the left or right.
- Press and hold PAUSE** to insert a dialing pause (for entering numbers only).
- Press **0** to add a space (for entering names only).

Dial a speed dial number
Press 1 or 2 on the pendant to dial the corresponding speed dial number.

Telephone operations

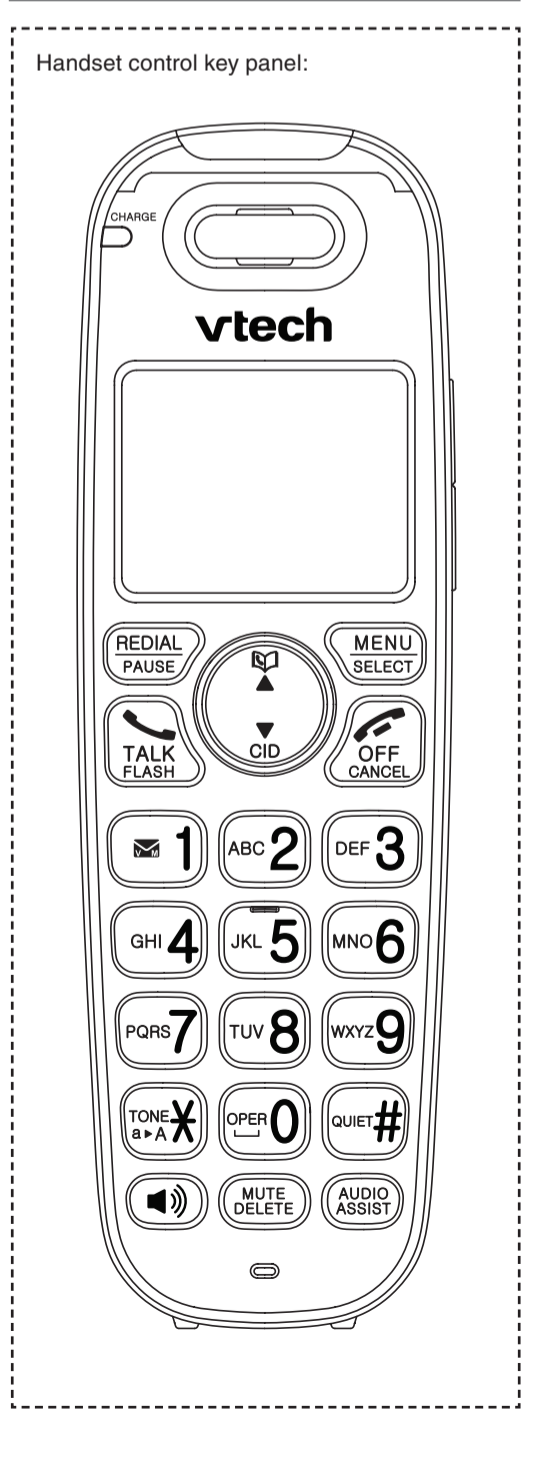

Make a call
Press **CALL** or **CALL** on the handset, and then dial the telephone number.

- Press 1 or 2 on the pendant to dial the corresponding speed dial number.

Answer a call
Press **ANS** or any of the dialing key on the handset.

End a call:
Press **OFF** or place the handset back in the telephone base or charger.

Volume
During a call, press **VOL-** or **VOL+** to adjust the listening volume.

Mute
The mute function allows you to hear the other party but the other party cannot hear you.

- During a call, press **MUTE**. The handset displays **Muted** briefly and **MUTE** icon until the mute function is turned off.
- Press **MUTE** again to resume the conversation. The handset displays **Microphone On** briefly.

Join a call in progress
You can use up to four handsets and pendants at a time on an outside call.

To join a call with a handset:
When a handset is already on a call, press **CALL** or **CALL** to join the call.

To join a call with a pendant:
Press **CALL** to join a call.

Call waiting
When you subscribe to call waiting service from your telephone service provider, you hear an alert tone if there is an incoming call while you are already on a call.

Review and dial a redial list entry
Press **REDIAL** when the handset is not in use.

Transfer a call

While on an outside call, you can transfer the call from one handset to another system device.

- During a call, press **MENU**.
- Press **▼** or **▲** to choose **Transfer** and then press **SELECT**.
- Press **▼** or **▲** to choose a desired device and then press **SELECT**.

Find handset
Use this feature to find all system handsets and pendants.

To start paging:
Press **FIND HANDSET** on the right side of the telephone base when not in use. All idle handsets and pendants ring, and the handsets display **** Paging ****.

To end paging:
Press **FIND HANDSET** at the telephone base.

Join a call in progress
When you receive an outside call during an intercom call, there is an alert tone.

Phonebook
The phonebook can store up to 50 entries, which are shared by all handsets. Each entry may consist of a telephone number up to 30 digits, and a name up to 15 characters.

Redial list

Each handset stores the last 10 telephone numbers dialed. When there are already 10 entries, the oldest entry is deleted to make room for the new entry.

- Enter the number when the phone is not in use. Press **SELECT**, then go to Step 3.
- Press **MENU** when the phone is not in use, then press **▼** or **▲** to scroll to **Phonebook** and press **SELECT**. Press **▼** or **▲** to scroll to **Add contact**, and then press **SELECT**.
- Use the dialing keys to enter the number.
- Press **DELETE**.

Intercom

Use the intercom feature for conversations between two system devices.

- Press **MENU**, then press **▼** or **▲** to scroll to **Intercom** and then press **SELECT**.
- Press **▼** or **▲** to choose a desired device and then press **SELECT**.
- Press **▼** or **▲** to choose a desired device and then press **SELECT**.

Review a phonebook entry
Entries are sorted alphabetically.

Delete a phonebook entry
When the handset displays **Delete contact?**, press **SELECT**.

Edit a phonebook entry
When the desired entry displays, press **SELECT**.

Dial a phonebook entry
When the desired entry appears, press **CALL** or **CALL** to dial.

Mount the telephone base

- Connect the telephone line cord to the telephone base. Route it through the wall mount bracket, and then connect it to the wall jack.

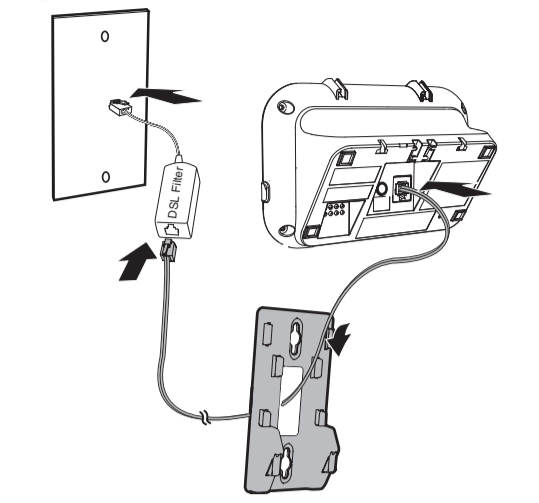

- Align and place the wall mount bracket on the standard wall plate.

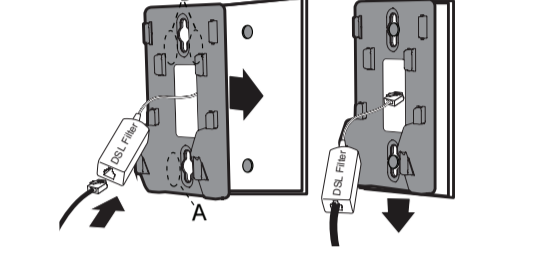

- Align and place the telephone base on the wall mount bracket, and then connect the power adapter.

